

## Wheel Speed Sensor — Rear

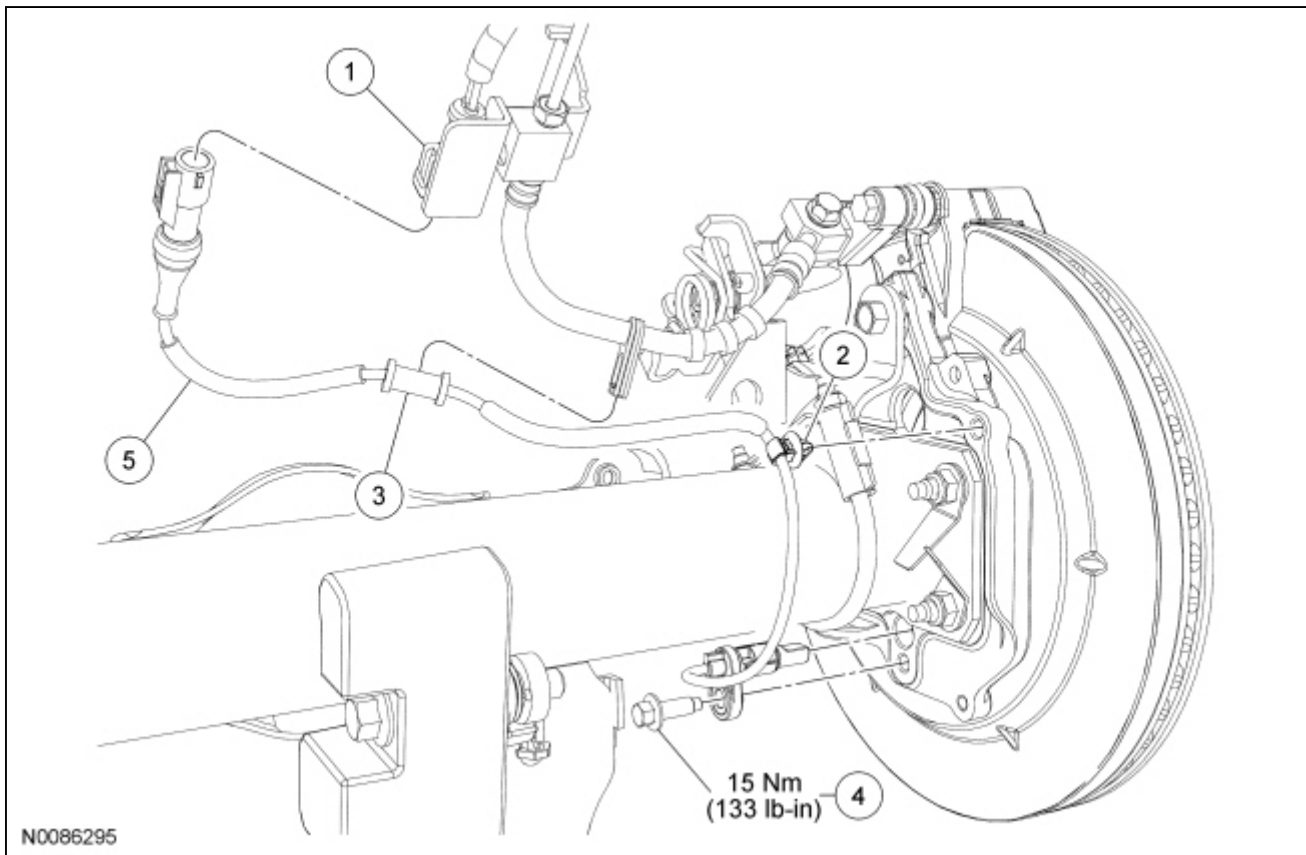

Item	Part Number	Description
1	—	Wheel speed sensor electrical connector (part of 14407)
2	—	Wheel speed sensor harness pin-type retainer (part of 2C190)
3	—	Wheel speed sensor grommet retainer (part of 2C190)
4	W500020	Wheel speed sensor bolt
5	2C190	Wheel speed sensor

### Removal and Installation

1. With the vehicle in NEUTRAL, position it on a hoist. For additional information, refer to [Section 100-02](#).
2. Disconnect the wheel speed sensor electrical connector.
3. Disconnect the 2 wheel speed sensor harness pin-type retainers.
4. Disconnect the wheel speed sensor grommet retainer from the brake hose clip.
5. Remove the wheel speed sensor bolt.
  - To install, tighten to 15 Nm (133 lb-in).
6. Remove the wheel speed sensor.
7. To install, reverse the removal procedure.

---